

No. 92 ADA Aisle Standard

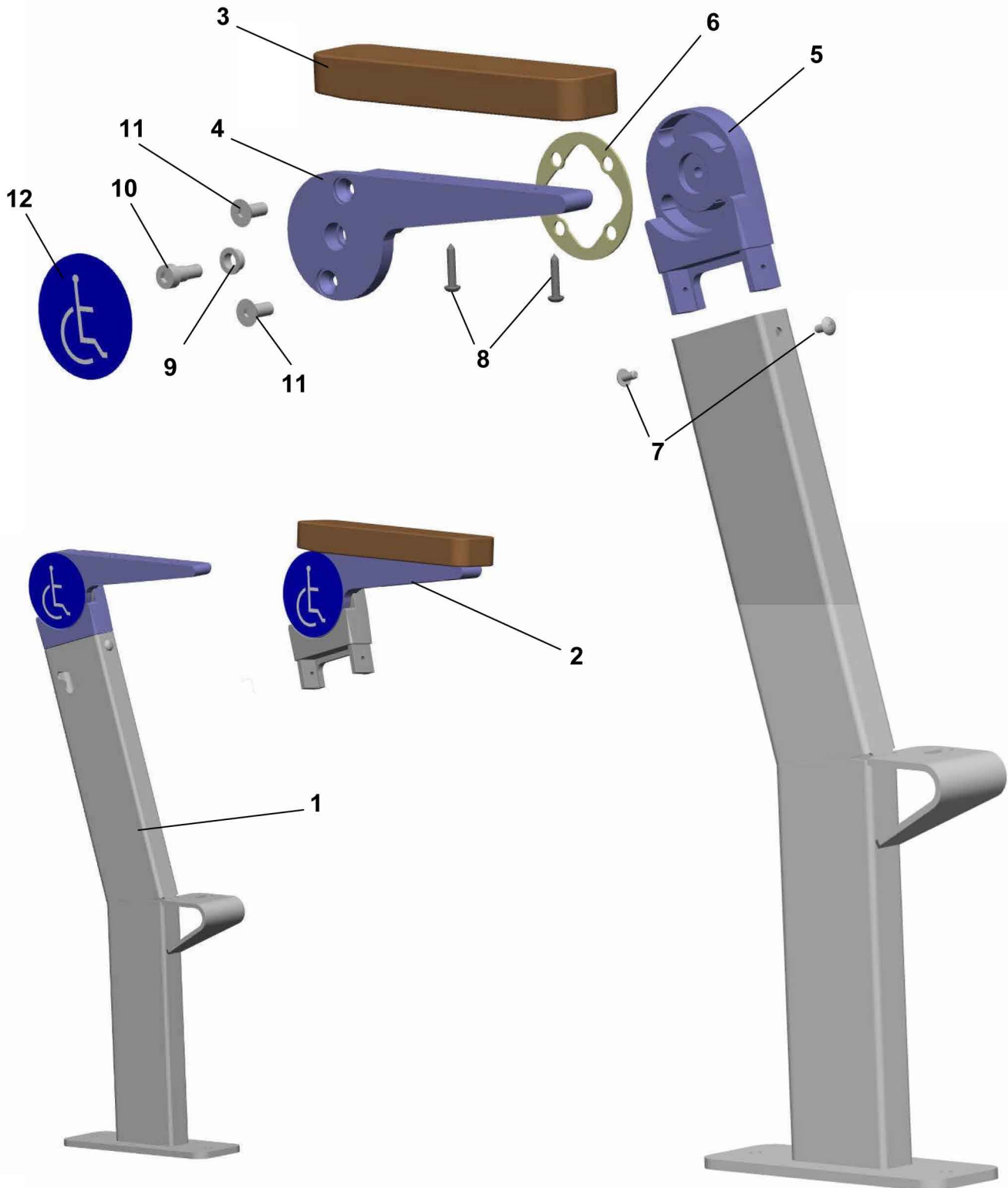

Professional Furnishings and Equipment, Inc.

2191 George Urban Blvd. • Depew, NY 14043
Phone: (716) 685-6885 • Fax: (716) 685-6825 • Web: www.profurnishings.com
E-mail: dblackburn@profurnishings.com





No. 92 ADA Aisle Standard

Order from the following components:

Ref #	Part Number	Description
1	92E+RH or LH	Complete ADA Standard with out without arm
2	9300+RA or LA	Complete ADA arm pivot (cast and arm)
3	93A	Arm only
4	93+RP or LP	Painted Cast Iron arm
5	9301P	Transfer arm pivot
6	9302	Washer
7	9307	10x50 Tek Screw to attach transfer arm pivot
8	10x1PH	Hardware to attach wood or laminate arm (2 per)
9	25095	Flange bushing for end arm bolt (1 per)
10	9308	Sholder Screw (1 per)
11	9306	Scocket head countersunk cap screw (2 per)
12	9305	3" ADA Sticker (round)

As part numbers do change please verify part numbers with the parts department.

When ordering please remember to specify the following:

1. Appropriate information from items designated under "General information- Standards". (RH, LH, Incline, Riser Height, etc.)
2. Specify Foot Option

Minimum Order is \$25.00

Professional Furnishings and Equipment, Inc.

2191 George Urban Blvd. • Depew, NY 14043
Phone: (716) 685-6885 • Fax: (716) 685-6825 • Web: www.profurnishings.com
E-mail: dblackburn@profurnishings.com

